

Pressure Gauge Syphons

Model 910.15

Accessories, Mechanical

Service intended

Pressure gauge syphons are intended to protect the pressure gauge from the effect of hot pressure media such as steam and also to reduce the effect of rapid pressure surges. Condensate of the pressure medium that is collected inside the coiled or U-shaped portion of the syphon prevents direct contact. When first installed the syphon should be filled with water or any other suitable separating liquid.

Design

Available are versions in strict compliance with DIN 16 282 and industrial standard syphons.

Forms

U-form to fit horizontal pressure tap
Trumpet form to fit vertical pressure tap

Standard features

Pressure connection

See table overleaf

Materials

Carbon steel St 35
Stainless steel 1.4571

Optional extras

Thread other than G. Special steel alloy
Stainless steel 1.4571 degreased for oxygen

1. Design per DIN 16 282

Design U-form	Max. tempera- ture °C	PN [bar]	Material	Product no.
Gauge side: LH/RH union G 1/2 2)				
Form A entry: G 1/2 A	120	100	St	9091181
Form B	300	80	St 3)	9091190
Entry: butt welding	400	63		
Form A entry: G 1/2 A	1)	1)	1.4571	9091220
Trumpet form				
Gauge side: LH/RH union G 1/2 2)				
Form C entry: G 1/2 A	120	100	St	9091203
Form D	300	80	St 3)	9091211
Entry: butt welding	400	63		
Form C entry: G 1/2 A	1)	1)	1.4571	9091238

- 1) Rating of carbon steel applies.
Consider long term corrosive attack of pressure fluid.
- 2) LH/RH union per DIN 16 283 not feasible with tapered threads such as NPT.
Rigid female thread is supplied instead.
- 3) St 35.8-I.



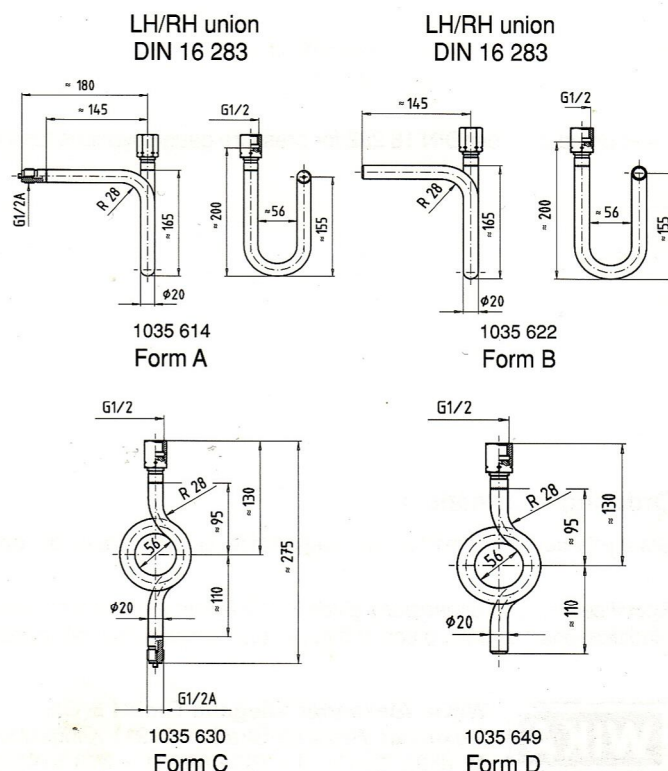

Carbon steel syphons DIN 16 282
Trumpet form C U-form A

Dimensions [mm]

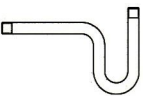
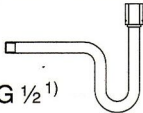
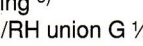

2. Industrial standard design

Design	Connection thread G	Pressure rating [bar]	Material	Dimensions [mm]						Product No.
				D	h	h ₁	l	r	s	
U-form Both sides male pipe thread 	G 1/4 ⁴⁾	25	St	-	170	130	225	26.5	13	9090649
	G 1/2 ⁴⁾	25	St	-	170	130	225	22.5	17	9090657
Entry: G 1/2 A Gauge side: LH/RH union G 1/2 ¹⁾ 	G 1/2 ⁴⁾	25	St	-	170	130	225	22.5	17	9090665
	G 1/2 ⁵⁾	160	St ²⁾	-	170	130	225	22.5	20	9090673
Entry butt welding ³⁾ Gauge side LH/RH union G 1/2 ¹⁾ 	G 1/2	25	St	-	170	130	-	22.5	-	9090681
Trumpet form Both sides male pipe thread 	G 1/4 ⁴⁾	25	St	64	240	120	-	-	13	9090592
	G 1/2 ⁴⁾	25	St	56	240	120	-	-	17	9090606
Entry: G 1/2 A Gauge side: LH/RH union G 1/2 ¹⁾ 	G 1/2 ⁴⁾	25	St	56	250	120	-	-	17	9090614
	G 1/2 ⁵⁾	160	St	56	275	120	-	-	20	9090622

1) LH/RH union per DIN 16 283 not feasible with tapered threads such as NPT.

2) St 35.8-l.

3) Chamfered for root welding.

4) Thread machined on pipe.

5) With butt welding nozzle form 4.

Dimensions

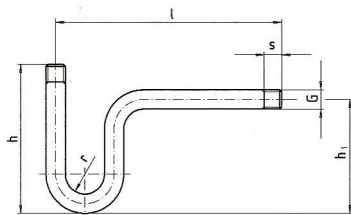

1035 665
U-form

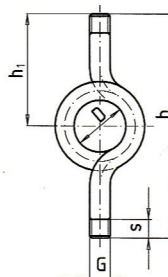

1035 673
Trumpet form

Weld-on adapter per DIN 16 282 for pressure gauge syphons form 4 and 6 see data sheet AM 09.05

Ordering information

State product No. or model / connection size IN-OUT / material / optional extras

Specifications and dimensions given in this leaflet represent the state of engineering at the time of printing. Modifications may take place and materials specified may be replaced by others without prior notice.



WIKA Alexander Wiegand GmbH & Co.

Alexander-Wiegand-Straße · 63911 Klingenberg

☎ (0 93 72) 132-0 · ☎ 6 89 231 · ☎ (0 93 72) 132-406/414